



Sodor Fun Time Station

User's Manual



vtech[®]

Dear Parent,

*At VTech® we know that a child's imagination is a truly wonderful thing and needs to be developed and nurtured. That's why we created the **Thomas & Friends™** learning series of interactive learning toys to stimulate children's imaginations, while also teaching vital preschool concepts such as the letters, numbers, phonics, counting, vocabulary and music.*

*Through the use of unique technology and engaging child-directed role-play scenarios, **Thomas & Friends™** characters magically come to life to guide children through learning activities. These engaging characters foster children's critical reasoning skills, enhance their fine motor skills and engage them in exciting role-play activities for endless hours of learning fun.*

At VTech® we know that a child has the ability to do great things. That's why all of our electronic learning products are uniquely designed to develop a child's mind and allow them to learn to the best of their ability. We thank you for trusting VTech® with the important job of helping your child learn and grow!

Sincerely,

Your Friends at VTech®

Other VTech® toys, visit www.vtech.com.

*To learn more about **Thomas & Friends™** visit www.thomasandfriends.com*

INTRODUCTION

Thank you for purchasing the **VTech® Thomas & Friends™ Sodor Fun Time Station** learning toy!

The **VTech® Thomas & Friends™ Sodor Fun Time Station** provides fun learning for little engineers! Preschoolers learn letters, numbers, shapes, following directions and more with Thomas™ and his friends. The removable activity panel has seven different sections to encourage role-play fun. Colorful number buttons feature ten different Thomas & Friends™ characters!

CLOCK WITH
SPINNING HAND

FLIPPING STORY PAGE

SIR TOPHAM HATT
SLIDER

ON/OFF/
SWITCH

3 SHAPE
BUTTONS

UP/DOWN
JOYSTICK WITH
FLASHING LIGHTS

SPINNING ROLLER
WITH THOMAS
POINTER

TEN NUMBERED
CHARACTER
BUTTONS

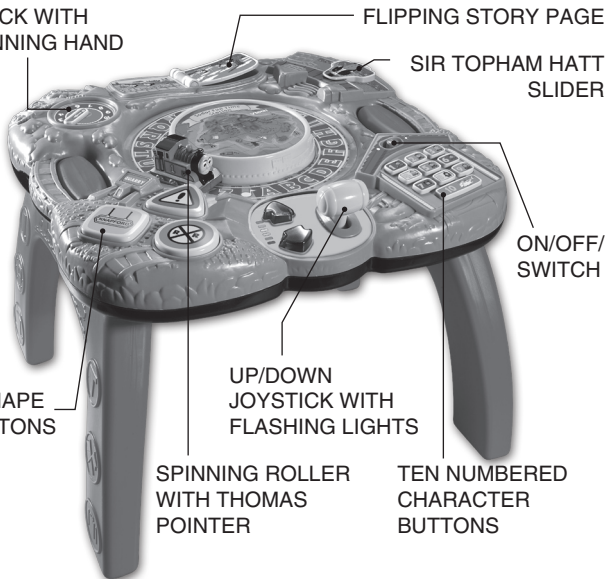

INCLUDED IN THIS PACKAGE

- One VTech® Thomas & Friends™ Sodor Fun Time Station
- One user's manual

WARNING:

All packing materials such as tape, plastic sheets, wire ties and tags are not part of this toy, and should be discarded for your child's safety.

GETTING STARTED

BATTERY INSTALLATION

1. Make sure the unit is turned **OFF**.
2. Locate the battery cover at the bottom of the unit. Use a coin or screwdriver to loosen the screw.
3. Install 2 new 'AA' batteries following the diagram inside the battery box.
4. Replace the battery cover and tighten the screw to secure.

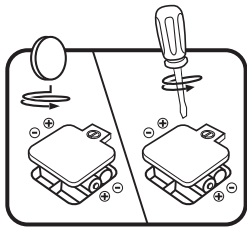

BATTERY NOTICE

- The use of new alkaline batteries is recommended for maximum performance.
- Install batteries correctly observing the polarity (+, -) signs to avoid leakage.
- Do not mix old and new batteries.
- Do not mix batteries of different types: alkaline, standard (carbon-zinc) or rechargeable (nickel-cadmium).

- Remove the batteries from the equipment when the unit will not be used for an extended period of time.
- Always remove exhausted batteries from the equipment.
- Do not dispose of batteries in fire.
- Do not attempt to recharge ordinary batteries.
- The supply terminals are not to be short-circuited.
- Only batteries of the same and equivalent type as recommended are to be used.

WE DO NOT RECOMMEND THE USE OF RECHARGEABLE BATTERIES.

TO ENSURE YOUR CHILD'S SAFETY, THIS PRODUCT MUST BE ASSEMBLED BY AN ADULT.

When used as a play table with the legs attached, please ensure the legs are securely locked into position before giving this toy to a child.

ASSEMBLY INSTRUCTIONS

1. Insert the legs one at a time by pushing them into the holes on either side of the table top. Push the legs until they snap into place. Pull the legs to ensure they are securely locked into position.
2. To remove the legs, locate the release tabs on the bottom of the table top inside the legs. Press the release tabs inward and pull the legs out to remove.

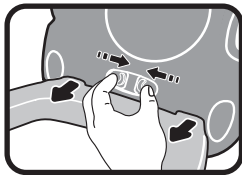
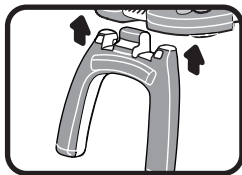

PRODUCT FEATURES

1. ON/OFF SWITCH

To turn the unit **ON**, slide the **ON/OFF SWITCH** to the **ON** (☉) position.
To turn the unit **OFF**, slide the **ON/OFF SWITCH** to the **OFF** (●) position.

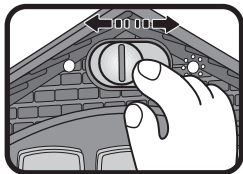

2. VOLUME CONTROL SWITCH

To adjust the volume, slide the **VOLUME CONTROL SWITCH** on the bottom of the unit to the **LOW** (🔊) or **HIGH** (🔊) **VOLUME** position.

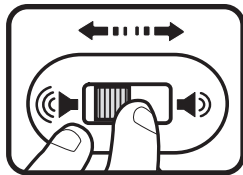

3. AUTOMATIC SHUT-OFF

To preserve battery life, the **VTech® Thomas & Friends™ Sodor Fun Time Station** will automatically power-down after approximately 40 seconds without input. The unit can be turned on again by pressing any button.

ACTIVITIES

1. Slide the **ON/OFF SWITCH** to turn the unit on. You will hear Thomas' whistle and Sir Topham Hatt telling a story about Thomas™ and his friends. Lights will flash with the sounds.

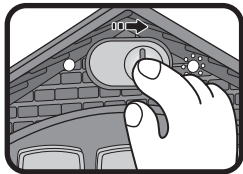

2. Flip the book's page. You will hear the second part of the Thomas & Friends™ story. Lights will flash with the sounds.

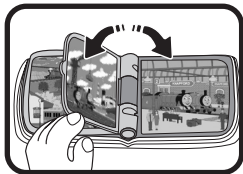

3. Roll Thomas™ along the alphabet track. Thomas™ shows the letters of the alphabet. Push Thomas™ quickly over the letters and hear whistles and music for 'The Alphabet Song.' Lights will flash with the sounds.

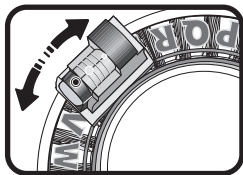

4. Move the joystick up or down to drive the engine! Move the joystick up to learn about a green light. You'll hear a fun phrase and engine chugging sound effects. Move the joystick down to learn about a red light. You'll hear a fun phrase and engine braking sound effects. The lights will flash with the sounds.

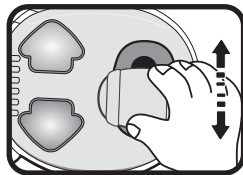

5. Slide the Sir Topham Hatt slider and he'll ask you if you want to meet Thomas™ and his friends. Push the number buttons to answer the questions. Lights will flash with the sounds.



6. Press the ten number buttons to learn numbers. You'll meet Thomas™ and nine other friends. Keep pressing the buttons to play games. Find each engine's letter on the alphabet track. Lights will flash with the sounds.



Number 1 button: Thomas™

Number 2 button: Edward

Number 3 button: Henry

Number 4 button: Gordon

Number 5 button: James

Number 6 button: Percy

Number 7 button: Toby

Number 8 button: Emily

Number 9 button: Salty

Number 10 button: Harold

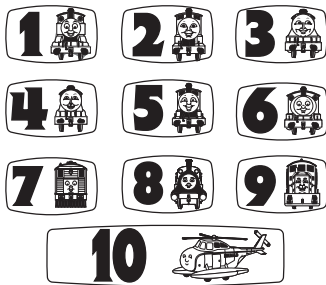

7. Spin the hour hand of the clock to learn about four different times of day. Lights will flash with the sounds.

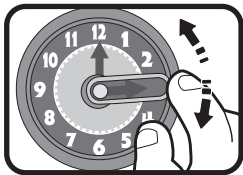

8. Press the shape buttons to learn about shapes and hear melodies. The lights will flash with the sounds. When melodies are playing, press all the buttons on the board to hear their sound effects over the melodies.



9. If there is no input to the unit after approximately ten seconds, you will hear Sir Topham Hatt ask you to turn the page to hear more of the story. After another ten seconds if there is still no input, you will hear Thomas' whistle and 'The Alphabet Song' melody. After another ten seconds if there is still no input, you will hear the phrase "Full steam ahead" and train chugging sounds. If there continues to be no input to the unit, you will hear Sir Topham Hatt kindly say, "Bye bye," then the unit will automatically power-down.

CARE & MAINTENANCE

1. Keep the unit clean by wiping it with a slightly damp cloth.
2. Keep the unit out of direct sunlight and away from any direct heat source.
3. Remove the batteries when the unit will not be in use for an extended period of time.
4. Do not drop the unit on hard surfaces and do not expose the unit to moisture or water.

TROUBLESHOOTING

If your **VTech® Thomas & Friends™ Sodor Fun Time Station** stops working or does not turn on:

1. Please turn the unit **OFF**.
2. Interrupt the power supply by removing the batteries.
3. Let the unit stand for a few minutes, then replace the batteries.
4. Turn the unit **ON**. The unit should now be ready to play again.
5. If the product still does not work, replace batteries with an entire new set.

If the problem persists, please call our Consumer Services Department at 1-800-521-2010 in the U.S. or 1-877-352-8697 in Canada, and a service representative will be happy to help you.

For information on this product's warranty, please call **VTech®** at 1-800-521-2010 in the U.S. or 1-877-352-8697 in Canada.

TECHNICAL SUPPORT

If you have a problem that cannot be solved by using this manual, we encourage you to visit us online or contact our Consumer Services Department with any problems and/or suggestions that you might have. A support representative will be happy to assist you.

Before requesting support, please be ready to provide or include the information below:

- The name of your product or model number (the model number is typically located on the back or bottom of your product).
- The actual error message or problem you are experiencing.
- The actions you took right before the error message or problem occurred.

Internet: www.vtechkids.com

Phone: 1-800-521-2010 in the U.S. or 1-877-352-8697 in Canada

OTHER INFO

VTech® Electronics North America, L.L.C. and its suppliers assume no responsibility for any damage or loss resulting from the use of this handbook. VTech® Electronics North America, L.L.C. and its suppliers assume no responsibility for any loss or claims by third parties that may arise through the use of this software. VTech® Electronics North America, L.L.C. and its suppliers assume no responsibility for any damage or loss caused by deletion of data as a result of malfunction, dead battery, or repairs. Be sure to make backup copies of important data on other media to protect against data loss.

COMPANY : VTech® Electronics North America, L.L.C.

ADDRESS : 1155 W. Dundee Road, Suite 130, Arlington Heights, IL 60004, USA

TEL NO.: (847) 400-3600

IMPORTANT NOTE:

Creating and developing **VTech® Thomas & Friends™** learning products is accompanied by a responsibility that we at **VTech®** take very seriously. We make every effort to ensure the accuracy of the information which forms the value of our products. However, errors sometimes can occur. It is important for you to know that we stand behind our products and encourage you to call our Consumer Services Department at 1-800-521-2010 in the U.S. or 1-877-352-8697 in Canada with any problems and/or suggestions that you might have. A service representative will be happy to help you.

Note:

This equipment has been tested and found to comply with the limits for a Class B digital device, pursuant to Part 15 of the FCC Rules. These limits are designed to provide reasonable protection against harmful interference in a residential installation. This equipment generates, uses and can radiate radio frequency energy and, if not installed and used in accordance with the instructions, may cause harmful interference to radio communications. However, there is no guarantee that interference will not occur in a particular installation. If this equipment does cause harmful interference to radio or television reception, which can be determined by turning the equipment off and on, the user is encouraged to try to correct the interference by one or more of the following measures:

- Reorient or relocate the receiving antenna.
- Increase the separation between the equipment and receiver.
- Connect the equipment into an outlet on a circuit different from that to which the receiver is connected.
- Consult the dealer or an experienced radio/TV technician for help.

Caution: Changes or modifications not expressly approved by the party responsible for compliance could void the user's authority to operate the equipment.



HiT entertainment

Thomas & Friends™ Sodor Fun Time Station



CREATED BY BRIT ALLCROFT

Based on The Railway Series by The Reverend W Awdry. © 2007 Gullane (Thomas) Limited. Thomas the Tank Engine & Friends and Thomas & Friends are trademarks of Gullane (Thomas) Limited.

Thomas the Tank Engine & Friends & Design is Reg. U.S. Pat. & Tm. Off.

© 2007 VTech

Printed in China

91-77500-000-006 (美)